

R-WB Self-drilling screws for steel

Double-threaded screw for trapezoidal steel sheet – max thickness of 2 x 1.25mm



Approvals and Reports

- ETA-09/0346



Product information

Features and benefits

- Hardened thread surface
- High quality anti-corrosion coating guarantees resistance of 15 Kesternich cycles.
- The shape and type of thread is designed specifically for connecting to metal sheets
- The drill point is designed to provide a fast and hassle-free installation. Sharp point of the drill prevents movement of the surface of the fixture.
- Reduced drilling point ensures optimal tightness and correct hole diameter in thin metal sheets.
- Two types of threads: one designed for mounting into construction, second under head thread, prevents external panel dents and helps to seal the connection

Applications

- Installing insulation layers on flat roofs in conjunction with steel washer, which remains stable thanks to the double thread.

Base materials

Approved for use in:

- Metal Sheet & Profiles
- Structural Steel

Installation guide

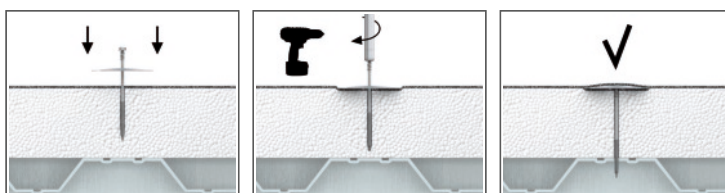

1. Position POW washer on insulation and insert WB screw
2. Using drilling machine, drive the screw into substrate until fixing depth is reached

Product information

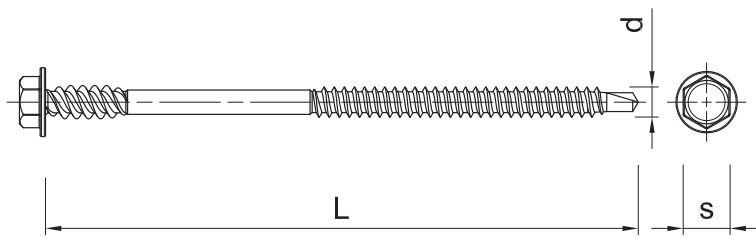

| Product Code | Screw | | |
|--------------|----------|--------|-----------|
| | Diameter | Length | Head size |
| | d | L | S |
| | [mm] | [mm] | [mm] |
| R-WB-48100 | 4.8 | 100 | 8 |
| R-WB-48120 | 4.8 | 120 | 8 |
| R-WB-48140 | 4.8 | 140 | 8 |
| R-WB-48160 | 4.8 | 160 | 8 |
| R-WB-48170 | 4.8 | 170 | 8 |
| R-WB-48180 | 4.8 | 180 | 8 |
| R-WB-48200 | 4.8 | 200 | 8 |
| R-WB-48220 | 4.8 | 220 | 8 |

Installation data

| Substrate | | | Steel |
|------------------------------|-----------|------|-------|
| Hole diameter in substrate | d_o | [mm] | - |
| Min. hole depth in substrate | h_o | [mm] | - |
| Min. installation depth | h_{nom} | [mm] | - |
| Min. substrate thickness | h_{min} | [mm] | 0.75 |
| Min. spacing | s_{min} | [mm] | 120 |
| Min. edge distance | c_{min} | [mm] | 30 |
| Screw diameter | d | [mm] | 4.8 |

Product commercial data

| Size | Product Code | Screw | Quantity [pcs] | | | Weight [kg] | | | Bar Codes |
|------|--------------------------|-------------|----------------|-------|--------|-------------|-------|--------|---------------|
| | | Length [mm] | Box | Outer | Pallet | Box | Outer | Pallet | |
| Ø4.8 | R-WB-48100 ¹⁾ | 100 | 100 | 1200 | 28800 | 1.11 | 13.3 | 348.5 | 5906675102436 |
| | R-WB-48120 ¹⁾ | 120 | 100 | 1200 | 28800 | 1.30 | 15.5 | 403.0 | 5906675102443 |
| | R-WB-48140 ¹⁾ | 140 | 100 | 1200 | 28800 | 1.47 | 17.6 | 452.5 | 5906675102467 |
| | R-WB-48160 ¹⁾ | 160 | 100 | 1200 | 28800 | 1.66 | 19.9 | 508.7 | 5906675102474 |
| | R-WB-48170 ¹⁾ | 170 | 100 | 1200 | 28800 | 1.73 | 20.8 | 528.2 | 5906675102498 |
| | R-WB-48180 ¹⁾ | 180 | 100 | 100 | 16800 | 1.89 | 1.89 | 347.4 | 5906675102504 |
| | R-WB-48200 ¹⁾ | 200 | 100 | 100 | 16800 | 2.1 | 2.1 | 377.3 | 5906675102511 |
| | R-WB-48220 ¹⁾ | 220 | 100 | 100 | 16800 | 2.3 | 2.3 | 407.5 | 5906675102535 |

1) ETA-09/0346