

The approved system for building renovation

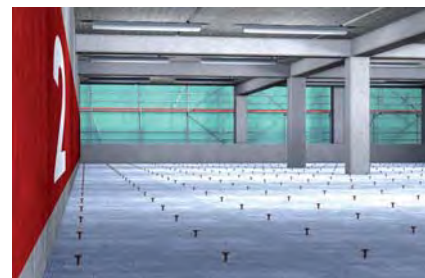

Upgrade of bridges



Reinforcement of ceilings

VERSIONS

- Zinc-plated concrete steel bar B500B

BUILDING MATERIALS

Approved for:

- Concrete C20/25 to C50/60, cracked and non-cracked
- Fixing in old concrete B 25 to B 55

CERTIFICATES



ADVANTAGES

- Due to its geometry and ease of installation, FCC is the rapid and economic alternative compared to the conventional installation method with bent iron.
- Dimensioning of the anchorage is possible thanks to the building approval. Thus, the system offers maximum security.
- Variable anchoring depths allow for ideal adaptation to the load to be applied, and ensure an optimised installation time and use of materials.
- Depending on site conditions, the FCC can be anchored, in compliance with the approval, with the injection mortars FIS SB or FIS EM Plus.
- In conjunction with FIS EM Plus, FCC is also approved for use in diamond-drilled drill holes.

APPLICATIONS

- Bridge repairs
- Increasing load capacity of bridges
- Increasing loads of ceilings during conversion, for example
- Reinforcement of foundations, piers, columns and walls
- Renovation of car park ceilings following corrosion damage

FUNCTIONING

- The system consists of injection mortar (FIS SB or FIS EM Plus) and the concrete-concrete shear connector FCC.
- The mortar is injected bubble-free from the drill hole base.
- The mortar adheres the drill hole wall to the shear connector FCC.
- The shear connector is set manually, by lightly rotating it until it reaches the drill hole base.
- The tensile and shear forces arising in the joints between the old and new concrete are absorbed by the FCC-H and safely redirected.

INSTALLATION IN CONCRETE WITH FIS SB OR FIS EM PLUS AND FCC-H

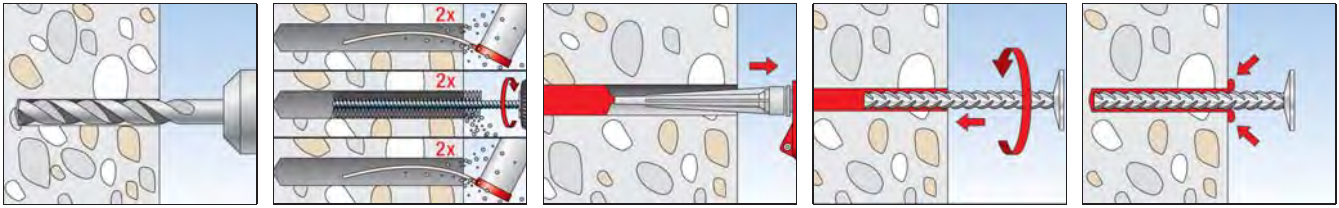

TECHNICAL DATA

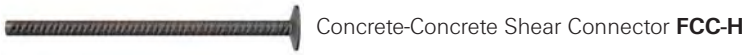

Item	Art.-No.	Approval DIBt	Drill hole diameter d_0 [mm]	Rebar diameter [mm]	Anchor length [mm]	Min. / standard anchorage depth [mm]	Min. / standard fill quantity e.g. FIS SB [scale units]	Sales unit [pcs]
FCC-H 10 x 180	520081	●	12	10	180	60/120	2/4	100
FCC-H 12 x 230	520082 ¹⁾	●	14	12	230	70/155	3/7	100
FCC-H 14 x 290	520083 ¹⁾	●	18	14	290	75/195	6/14	50
FCC-H 16 x 360	520085 ¹⁾	●	20	16	360	80/240	7/20	25

¹⁾ Delivery time on request.