



BUREAU
VERITAS

Lloyd's
Register

TYPE
APPROVED



Hilti Corrosion
handbook / DFTM



A4
316

Equivalent
Corrosion
Resistance

		Use with			
X-BT-ER M8/SN 8	X-BT-ER M10/SN 8	SF BT 22-A	DX 351-BT	X-BT 1/4" - 20Nm/ 14,8 ft lb	S-NSP 1/4" HKH 17
X-BT-ER W10/SN 8					S-NS 3/8" C 95/3 3/4"

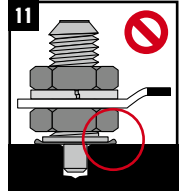
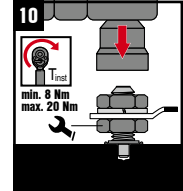
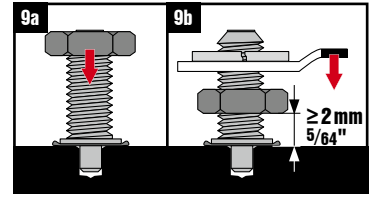
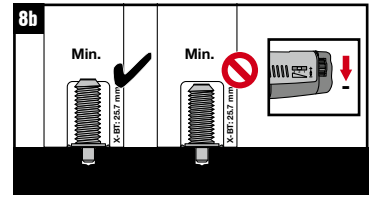
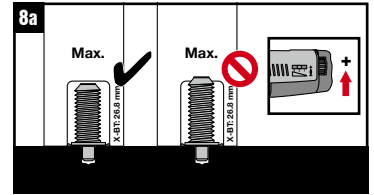
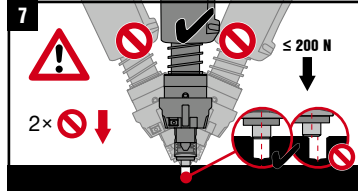
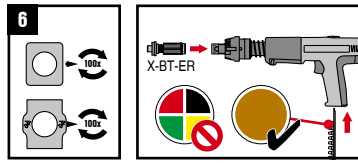
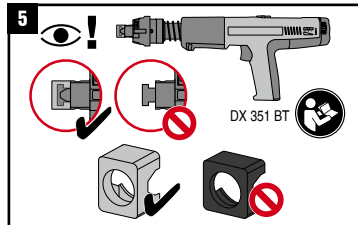
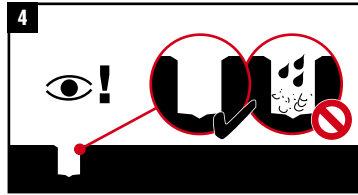
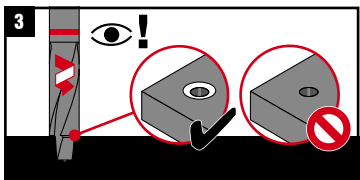
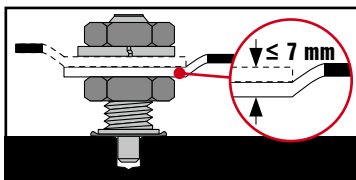
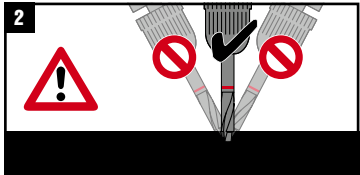
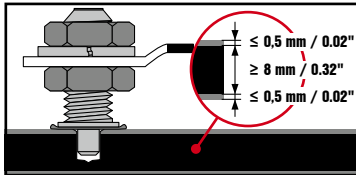
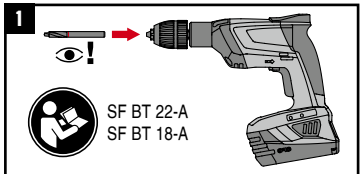
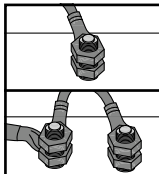



X-BT-ER M8, M10/W10 SN 8



BUREAU VERITAS

Lloyd's Register

TYPE APPROVED



Hilti Corrosion handbook / DFTM

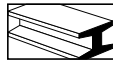
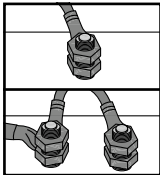
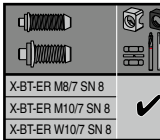

A4 316 Equivalent Corrosion Resistance

Use with			
SF BT 22-A	SF BT 18-A	BX 3-BT	S-NS13 C 95/3 3/4"
			S-NSP 1/4" HKH 17
			S-NS 3/8 C 95/3 3/4"

