

R-PLS Plastic Mesh Sleeves

The sleeve for reduced mortar consumption and optimal mechanical interlock

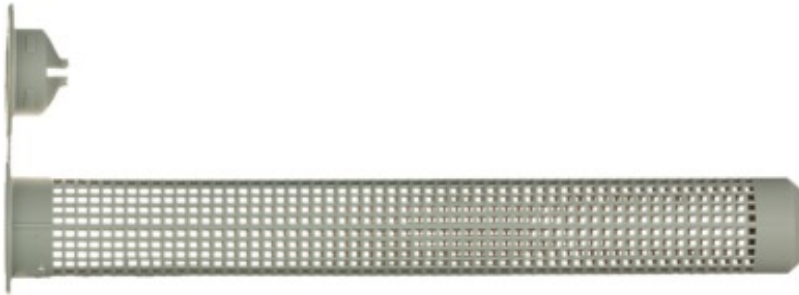

Product information

Features and benefits

- Ensures that the anchor rod is properly centred.
- Reduces consumption of resin
- User-friendly installation in hollow substrates
- Size must be adjusted to the hole depth and diameter
- Hole cleaning is not necessary

Applications

- For use with R-STUDS threaded rods in hollow base materials
- [English]: Stosowana w podłożach pustych.

Installation guide

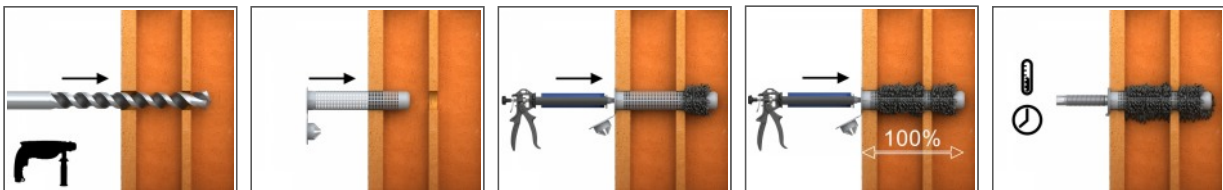

1. Drill the hole and clean it up.
2. Insert the sleeve in the hole.
3. Apply the resin in 100 % of depth of the hole and close the cap.
4. Place the stud in the sleeve and wait until full curing of the resin, as stated on the product label.
5. After full curing of the anchor, install the fixed element with proper torque.

Product information

Size	Product Code	Plastic mesh sleeve size	Stud size	Raw material	Colour
		dxl			
		[mm]			
Ø12	R-PLS-12050-10	12x50	M8	polypropylene	transparent
Ø_16	R-PLS-16085-10	16x85	M10-M12	polypropylene	transparent
	R-PLS-16130-10	16x130	M10-M12	polypropylene	transparent
Ø_20	R-PLS-20085-10	20x85	M16	polypropylene	transparent

Product commercial data

Size	Product Code	Stud size	Quantity [pcs]			Weight [kg]			Bar Codes
			Box	Outer	Pallet	Box	Outer	Pallet	
Ø12	R-PLS-12050-10	M8	10	700	8400	0.02	1.40	46.8	5906675377520
Ø_16	R-PLS-16085-10	M10-M12	10	500	6000	0.05	2.5	60.0	5906675347547
	R-PLS-16130-10	M10-M12	10	400	4800	0.06	2.6	60.7	5906675347554
Ø_20	R-PLS-20085-10	M16	10	400	4800	0.04	1.68	50.2	5906675291864