

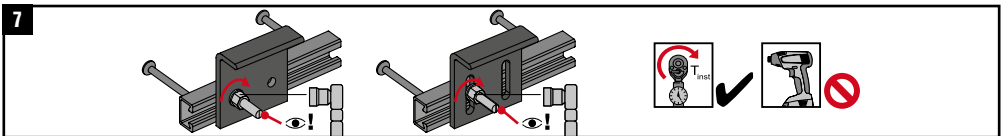

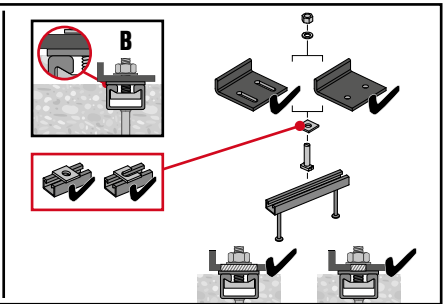

	HBC-40/22-N	HAC-C 40/22, HAC-C-P 40/22, HAC-C-P 40L	
	HBC-50/30-N	HAC-C 50/30, HAC-C-P 50/30, HAC-C-P 50L, HAC-C 52/34	

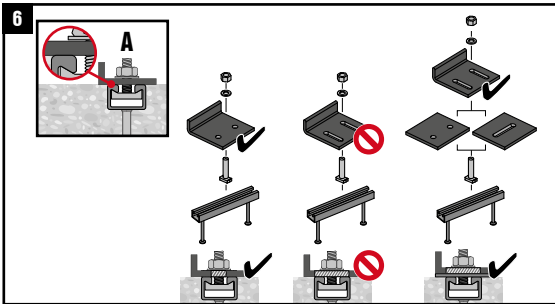
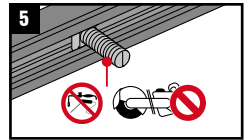
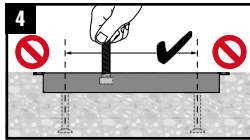
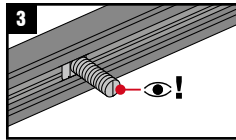
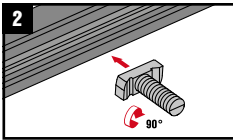

Anchor Channel	Channel Bolt	T <sub>inst</sub> [Nm]	
HAC-C-P 40/22	HBC-40/22-N M16	8.8	8.8
HAC-C-P 40L		160	160
HAC-C 40/22		60	160
HAC-C-P 50/30	HBC-50/30-N M16	185	185
HAC-C-P 50L			
HAC-C 50/30			
HAC-C 52/34			
HAC-C-P 50/30	HBC-50/30-N M20	320	320
HAC-C-P 50L			
HAC-C 50/30			
HAC-C 52/34			

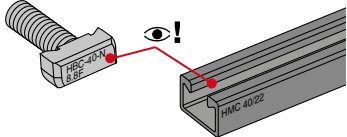
<b>1</b>  	 HBC-40/22-N	 HMC 40/22
	HBC-50/30-N	HMC 50/30, HMC 52/34

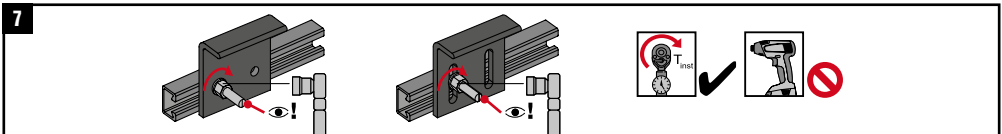
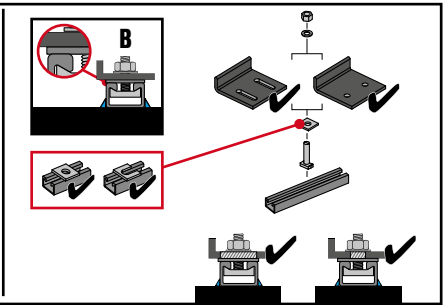
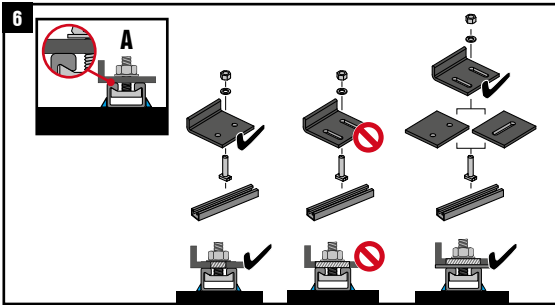
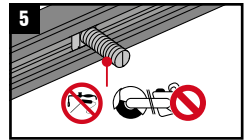
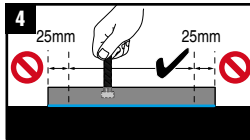
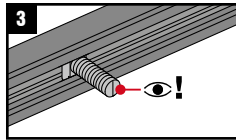
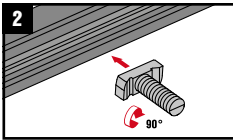

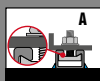
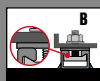
Mounting Channel	Channel Bolt	$T_{inst}$ [Nm]	
		 	8.8
HMC 40/22	HBC-40/22-N M16		160
HMC 50/30, HMC 52/34	HBC-50/30-N M16		185
HMC 50/30, HMC 52/34	HBC-50/30-N M20		320