

TFIX-8M Facade fixing with metal nail

Versatile hammer-in facade fixing with steel nail recommended for ETICS.



Approvals and Reports

- ETA-07/0336



Product information

Features and benefits

- Simple installation in all standard substrates (A,B,C).
- Excellent plate stiffness (value 1.0 kN/mm) ensures smooth elevation surface and stable insulation system.
- The long plastic overmoulding on the TFIX-8M nail minimises thermal bridging (value 0.002W/K), contributing to energy-saving benefits.
- Unique nail design allows for high load-bearing capacities. This reduces the quantity of fixings required per square metre of insulation.
- The shortest embedment depth at the maximum strength parameters
- Pre-assembled expansion nail saves time and labour.

Applications

- External Thermal Insulation Composite Systems (ETICS)
- Polystyrene (EPS) boards
- Mineral wool (MW) boards
- Light wood wool building boards
- Polyurethane (PU) boards
- Cork boards

Base materials

Approved for use in:

- Concrete C12/15-C50/60 (Use category A)
- Solid Brick (Use category B)
- Solid Sand-lime Brick (Use category B)
- Hollow Brick (Use category C)
- Vertically-perforated clay block (Use category C)
- Hollow Sand-lime Brick (Use category C)
- Lightweight Concrete Block (Use category C)
- Hollow Lightweight Concrete Block (Use category D)

Installation guide

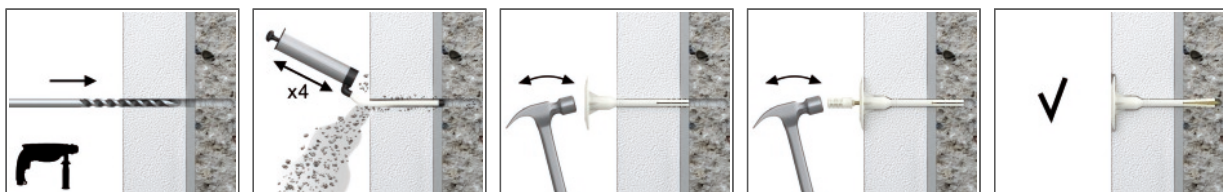

1. Drill a hole of required diameter and depth
2. Drilling depth of min 35-45mm in approved materials
3. Lightly tap the plastic sleeve through the insulation material into hole with a hammer, until fixing depth is reached and plastic sleeve flush with insulation material
4. Embedment depth of min 25mm in approved materials
5. Hammer the nail into the plastic sleeve until fixing is secure and flush with insulation material.
6. In soft insulation panels the fixing should be combined with insulation retaining plates KWL-90, KWL-110, KWL-140.

Product information

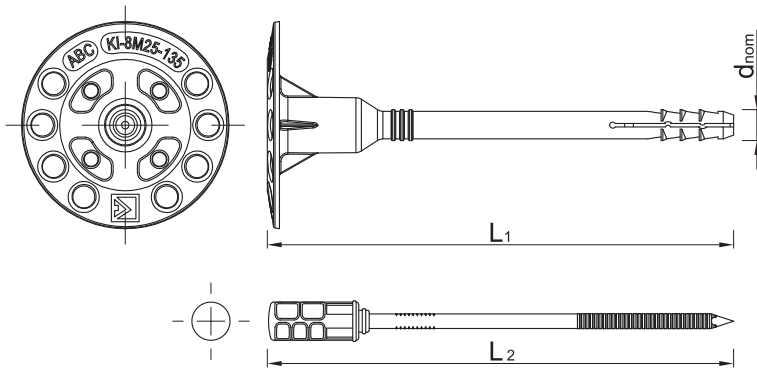

Size	Product Code	Fixing			Fixture
		Diameter	Length	Plate diameter	Recommended thickness
		d	L	D	t _{fix} A, B, C
[mm]					
Ø8	TFIX-8M-095	8	95	60	60
	TFIX-8M-115	8	115	60	80
	TFIX-8M-135	8	135	60	100
	TFIX-8M-155	8	155	60	120
	TFIX-8M-175	8	175	60	140
	TFIX-8M-195	8	195	60	160
	TFIX-8M-215	8	215	60	180
	TFIX-8M-235	8	235	60	200
	TFIX-8M-255	8	255	60	220
	TFIX-8M-275	8	275	60	240
TFIX-8M-295	8	295	60	260	

Installation data

Substrate			A, B, C
Hole diameter in substrate	d ₀	[mm]	8
Min. hole depth in substrate	h ₀	[mm]	35
Min. installation depth	h _{nom}	[mm]	25
Min. substrate thickness	h _{min}	[mm]	100
Min. spacing	s _{min}	[mm]	100
Min. edge distance	c _{min}	[mm]	100
Fixing diameter	d	[mm]	8

Basic performance data

Performance data for single anchor without influence of edge distance and spacing

Substrate		Concrete	Solid brick Mz	Sand-lime solid brick KS	Sand-lime perforated brick KSL	Perforated clay brick HLZ	Lightweight concrete solid block VBI	Lightweight concrete hollow block HBI	Lightweight concrete solid V
		Effective embedment depth h _{ef}	[mm]	25	25	25	25	25	25
MEAN ULTIMATE LOAD N_{Ru,m}									
TFIX-8M	[kN]	1.54	1.72	1.47	1.00	0.68	0.51	0.53	0.54
CHARACTERISTIC LOAD N_{Rk}									
TFIX-8M	[kN]	1.20	1.20	1.20	0.90	0.60	0.30	0.50	0.50

Basic performance data

Substrate		Concrete	Solid brick Mz	Sand-lime solid brick KS	Sand-lime perforated brick KSL	Perforated clay brick HLZ	Lightweight concrete solid block VBI	Lightweight concrete hollow block HBI	Lightweight concrete solid V
DESIGN LOAD N_{rd}									
TFIX-8M	[kN]	0.60	0.60	0.60	0.45	0.30	0.15	0.25	0.25
RECOMMENDED LOAD N_{rec}									
TFIX-8M	[kN]	0.43	0.43	0.43	0.32	0.21	0.11	0.18	0.18

Fixing type		TFIX-8M							
Plate resistance	[kN]	1.75							
Plate stiffness	[kN/mm]	1							
Point thermal transmittance	[W/K]	0.002							

Product commercial data

Size	Product Code	Fixing			Quantity [pcs]			Weight [kg]			Bar Codes
		Diameter [mm]	Length [mm]	Plate diameter [mm]	Box	Outer	Pallet	Box	Outer	Pallet	
Ø8	TFIX-8M-095 ¹⁾	8	95	60	200	200	9600	4.5	4.5	246.0	5906675188768
	TFIX-8M-115 ¹⁾	8	115	60	200	200	8000	5.1	5.1	234.2	5906675188775
	TFIX-8M-135 ¹⁾	8	135	60	200	200	8000	5.6	5.6	253.4	5906675188782
	TFIX-8M-155 ¹⁾	8	155	60	200	200	6400	6.2	6.2	226.8	5906675188799
	TFIX-8M-175 ¹⁾	8	175	60	200	200	6400	6.8	6.8	246.1	5906675188805
	TFIX-8M-195 ¹⁾	8	195	60	200	200	6400	7.4	7.4	265.5	5906675188812
	TFIX-8M-215 ¹⁾	8	215	60	100	100	4000	4.1	4.1	194.8	5906675188829
	TFIX-8M-235 ¹⁾	8	235	60	100	100	4000	4.4	4.4	204.6	5906675188836
	TFIX-8M-255 ¹⁾	8	255	60	100	100	4000	4.7	4.7	218.7	5906675188843
	TFIX-8M-275 ¹⁾	8	275	60	100	100	4000	4.9	4.9	226.8	5906675188850
TFIX-8M-295 ¹⁾	8	295	60	100	100	4000	5.3	5.3	240.4	5906675188867	

1) ETA-07/0336